

LEGEND

- APPROXIMATE LOCATION OF EXISTING HOME
- EDGE OF ROAD/TRAVELWAY
- APPROXIMATE LOCATION OF EXISTING SEPTIC SYSTEM
- APPROXIMATE LOCATION OF EXISTING PRIVATE WELL
- SEWER LINE
- FORCE MAIN
- WATER LINE
- LIMITED SERVICE AREA BOUNDARY

- REQUIRED UTILITY EASEMENT
- PROPOSED WATER LINE (9,450 LF)
- PROPOSED SEPTIC SYSTEM (28, SEE NOTES 1&2)
- UNSERVED HOME IN SERVICE AREA (30, SEE NOTE 2)
- VACANT LOT IN SERVICE AREA (25)
- INELIGIBLE SERVED HOME IN SERVICE AREA (7)
- UNSERVED HOME OUTSIDE SERVICE AREA (12)

- NOTES:
- PROPOSED SEPTIC SYSTEM PLACEMENTS ARE SCHEMATIC AND DO NOT REPRESENT PROPOSED LOCATIONS ON EACH LOT. SEPTIC SYSTEMS MUST BE AT LEAST 10-FT FROM THE HOUSE, PROPERTY LINE, AND THE WATER MAIN.
 - THE PROPOSED NUMBER OF SEPTIC SYSTEMS AND UNSERVED HOMES IN THE SERVICE AREA ASSUMES SEVEN HOMES WILL BE RELOCATED FROM THE DOWNTOWN AREA PRIOR TO CONSTRUCTION.

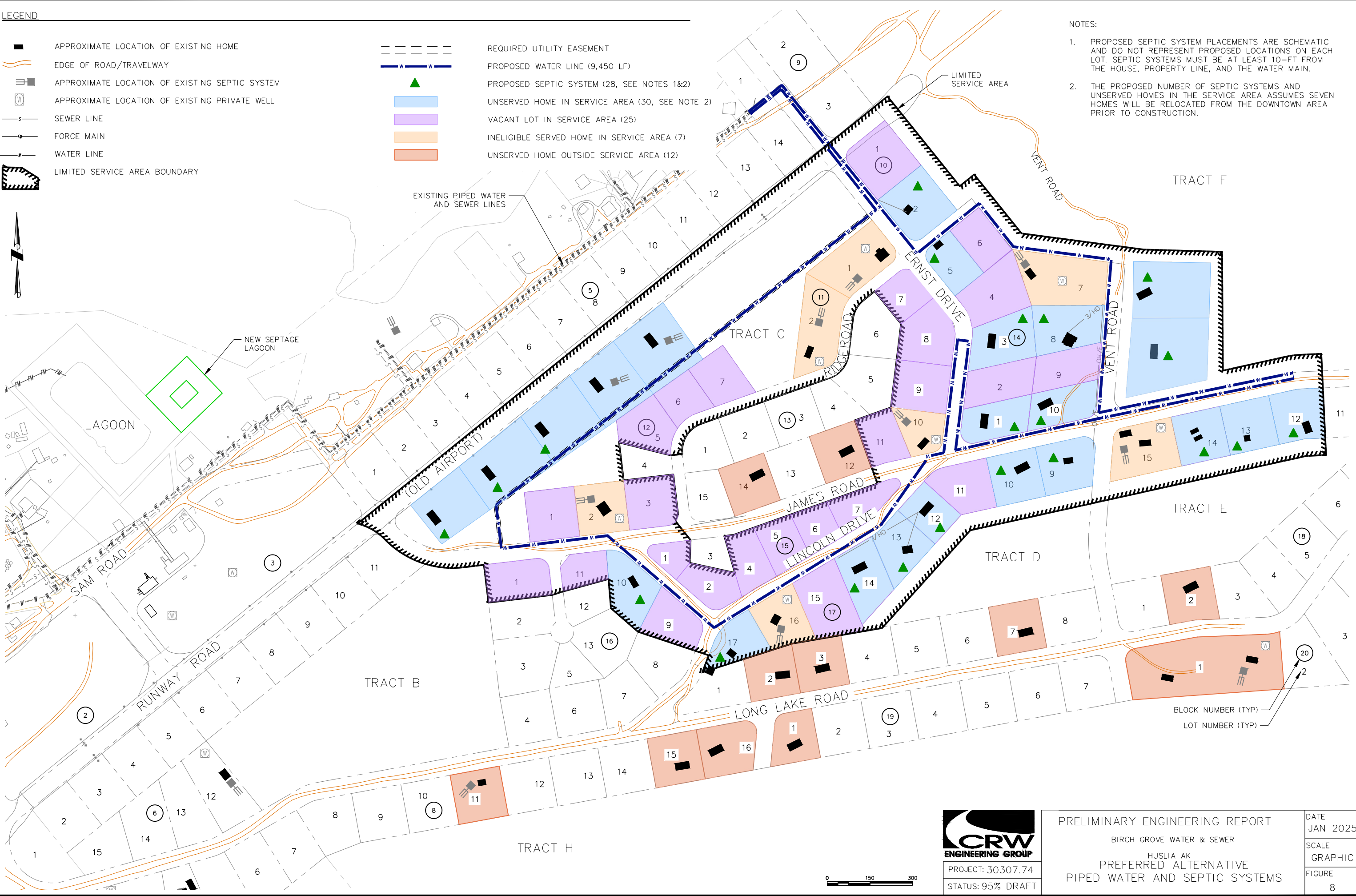

File: J:\JobsData\30307.74_Anthc - Huslia Water And Sewer_Per\00_CADD\02_Figures\01_PER\30307.74-Existing-Site.dwg

CRW
ENGINEERING GROUP

PROJECT: 30307.74
STATUS: 95% DRAFT

PRELIMINARY ENGINEERING REPORT
BIRCH GROVE WATER & SEWER
HUSLIA AK
PREFERRED ALTERNATIVE
PIPED WATER AND SEPTIC SYSTEMS

DATE
JAN 2025
SCALE
GRAPHIC
FIGURE
8